

WOOD DESTROYING PESTS AND ORGANISMS INSPECTION REPORT

Building No. 2108	Street CROMWELL CT	City Bakersfield	Zip 93304	Date of Inspection 1/7/2009	Number of Pages 4
----------------------	-----------------------	---------------------	--------------	--------------------------------	----------------------



RCB Inspections and Termite Control
 3400 Panama Ln. Suite F #194
 Bakersfield CA 93313
 Tel 661-398-2151 Fax 661-836-2645
 termitehawk@abcglobal.net

Report #: 10947
 Registration #: 4980
 Escrow #: =

Ordered by:	Property Owner and/or Party of Interest: 2108 CROMWELL CT Bakersfield CA 93304	Report sent to:
-------------	--	-----------------

COMPLETE REPORT LIMITED REPORT SUPPLEMENTAL REPORT REINSPECTION REPORT

GENERAL DESCRIPTION: ONE STORY, SINGLE FAMILY HOUSE. UNFURNISHED AND UNOCCUPIED.	Inspection Tag Posted: STORE ROOM
	Other Tags Posted:

An inspection has been made of the structure(s) shown on the diagram in accordance with the Structural Pest Control Act. Detached porches, detached steps, detached decks and any other structures not on the diagram were not inspected.

Subterranean Termites Drywood Termites Fungus / Dryrot Other Findings Further Inspection
 If any of the above boxes are checked, it indicates that there were visible problems in accessible areas. Read the report for details on checked

Diagram Not To Scale

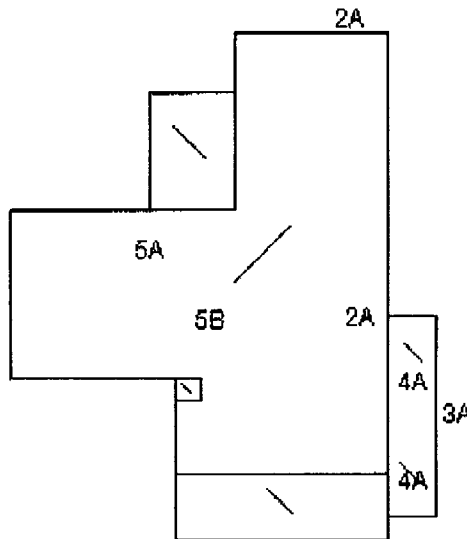

Front

Inspected By: James E. Blythe

State License No. FR18377

Signature:

Jim Blythe

You are entitled to obtain copies of all reports and completion notices on this property reported to the Structural Pest Control Board during the preceding two years. To obtain copies contact: Structural Pest Control Board, 1418 Howe Avenue, Suite 18, Sacramento, California, 95825-3204.

NOTE: Questions or problems concerning the above report should be directed to the manager of the company. Unresolved questions or problems with services performed may be directed to the Structural Pest Control Board at (916) 561-8708, (800) 737-8188 or www.pestboard.ca.gov.

RCB Inspections and Termite Control

Page 2 of inspection report

2108	CROMWELL, CT	Bakersfield	CA	93304
Address of Property Inspected		City	State	Zip
Stamp No.	1/7/09 Date of Inspection	10947 Co. Report No.	Escrow No.	

WHAT IS A WOOD DESTROYING PEST & ORGANISM INSPECTION REPORT? READ THIS DOCUMENT. IT EXPLAINS THE SCOPE AND LIMITATIONS OF A STRUCTURAL PEST CONTROL INSPECTION AND A WOOD DESTROYING PEST & ORGANISM INSPECTION REPORT.

A Wood Destroying Pest & Organism Inspection Report contains findings as to the presence or absence of evidence of wood destroying pests and organisms in visible and accessible areas and contains recommendations for correcting any infestations or infections found. The contents of Wood Destroying Pest & Organism Inspection Reports are governed by the Structural Pest Control Act and regulations.

Some structures do not comply with building code requirements or may have structural, plumbing, electrical, mechanical, heating, air conditioning or other defects that do not pertain to wood destroying organisms. A Wood Destroying Pest & Organism Inspection Report does not contain information on such defects, if any, as they are not within the scope of the licenses of either this company, or it's employees.

The Structural Pest Control Act requires inspection of only those areas which are visible and accessible at the time of inspection. Some areas of the structure are not accessible to inspection, such as the interior of hollow walls, spaces between floors, areas concealed by carpeting, appliances, furniture or cabinets. Infestations or infections may be active in these areas without visible and accessible evidence. If you desire information about areas that were not inspected, a further inspection may be performed at an additional cost. Carpets, furniture or appliances are not moved and windows are not opened during a routine inspection.

The exterior Surface of the roof was not inspected. If you want the water tightness of the roof determined, you should contact a roofing contractor who is licensed by the Contractor's State License Board.

This company does not certify or guarantee against any leakage, such as (but not limited to) plumbing, appliances, walls, doors, windows, any type of seepage, roof or deck coverings. This company renders no guarantee, whatsoever, against any infection, infestation or any other adverse condition which may exist in such areas or may become visibly evident in such area after this date. Upon request, further inspection of these areas would be performed at an additional charge.

In the event damage or infestation described herein is later found to extend further than anticipated, our bid will not include such repairs. **OWNER SHOULD BE AWARE OF THIS CLOSED BID WHEN CONTRACTING WITH OTHERS OR UNDERTAKING THE WORK HIMSELF/HERSELF.**

If requested by the person ordering this report, a re-inspection of the structure will be performed. Such requests must be within four (4) months of the date of this inspection. Every re-inspection fee amount shall not exceed the original inspection fee.

Wall paper, stain, or interior painting are excluded from our contract. New wood exposed to the weather will be prime painted, only upon request at an additional expense.

All pesticides and fungicides must be applied by a state certified applicator (sec. 8555 Business and Professions Code Division 3) and in accordance with the manufacturer's label requirements.

This company will reinspect repairs done by others within four months of the original inspection. A charge, if any, can be no greater than the original inspection fee for each reinspection. The reinspection must be done within ten (10) working days of request. The reinspection is a visual inspection and if inspection of concealed areas is desired, inspection of work in progress will be necessary. Any guarantees must be received from parties performing repairs.

"NOTICE: Reports on this structure prepared by various registered companies should list the same findings (i.e. termite infestations, termite damage, fungus damage, etc.). However, recommendations to correct these findings may vary from company to company. You have a right to seek a second opinion from another company."

This Wood Destroying Pest & Organisms Report DOES NOT INCLUDE MOLD or any mold like conditions. No reference will be made to mold or mold-like conditions. Mold is not a Wood Destroying Organism and is outside the scope of this report as defined by the Structural Pest Control Act. If you wish your property to be inspected for mold or mold like conditions, please contact the appropriate mold professional.

RCB Inspections and Termite Control

Page 3 of 4 of Standard Inspection Report

2108	CROMWELL CT	Bakersfield	CA	93304
Address of Property Inspected		City	State	Zip
Stamp No.	1/7/09	10947	=	
	Date of Inspection	Co. Report No.	Escrow No.	

SECTION I CONTAINS ITEMS WHERE THERE IS EVIDENCE OF ACTIVE INFESTATION, INFECTION OR CONDITIONS THAT HAVE RESULTED IN OR FROM INFESTATION OR INFECTION.

SECTION II ITEMS ARE CONDITIONS DEEMED LIKELY TO LEAD TO INFESTATION OR INFECTION BUT WHERE NO VISIBLE EVIDENCE OF SUCH WAS FOUND.

FURTHER INSPECTION ITEMS ARE DEFINED AS RECOMMENDATIONS TO INSPECT AREA(S) WHICH DURING THE ORIGINAL INSPECTION DID NOT ALLOW THE INSPECTOR ACCESS TO COMPLETE HIS INSPECTION AND CANNOT BE DEFINED AS SECTION I OR II.

2. DRYWOOD TERMITES:

2A - FINDING - Evidence of drywood termites noted in areas marked on diagram.

RECOMMENDATION - Cover entire structure(s) and fumigate for the elimination of drywood termites. Cover or remove accessible termite pellets. *Note*: When a property is fumigated, our crew must walk on the roof surfaces and perimeter areas of the building in order to put the tarp in place, and damage may occur to certain types of roofs, roofs eaves, roof ridges and/or roof corners. Neither RCB nor its licensed fumigator will assume any liability for such damage or consequential damage that may occur to roofs or roof coverings and areas below roofs.
SECTION 1

3. FUNGUS / DRYROT:

3A - FINDING - Fungus damaged wood noted fascia as indicated on diagram.

RECOMMENDATION - Replace fungus damaged wood at fascia. RCB will prime replaced wood. Painting is not included with this estimate.
SECTION 1

4. OTHER FINDINGS:

4A - FINDING - Water stains noted patio as indicated on diagram.

RECOMMENDATION - Owner to consult a licensed roofer for further inspection and recommendation for repair.
SECTION 2

5. FURTHER INSPECTION:

5A - FINDING - Stall shower pan marked on diagram was not water tested because water had been turned off.

RECOMMENDATION - Water is to be turned on for testing shower pan. We will re-inspect and issue a supplemental report of our new findings.
SECTION 2

5B - FINDING - Inaccessible area noted at bathtub plumbing access due to construction or storage marked on diagram.

RECOMMENDATION - If inspection of area(s) at plumbing access is required it must be made accessible. We will then re-inspect and issue a supplemental report of our new findings. RCB recommends further inspection of this area.
FURTHER INSPECTION IF REQUIRED

NOTE: When replacement material is used, an exact match cannot be guaranteed. All replacement material will be

RCB Inspections and Termite Control

Page 4 of 4 of Standard Inspection Report

2108 CROMWELL, CT Bakersfield CA 93304
 Address of Property Inspected City State Zip
 Stamp No. 1/1/09 10947 =
 Date of Inspection Co. Report No. Escrow No.

of current industry sizing.

NOTE: Fumigation is warranted for a period of two (2) years.

NOTE: RCB will prime replaced wood or finish-paint wood with owners provided paint. There is no paint match warranty.

NOTE: If termite or dryrot extends into inaccessible or hidden areas, a supplemental report will be issued and a new estimate to complete the repairs will be provided.

"Thank you for selecting our company to perform a structural pest control inspection on your property. Our inspectors have determined that your property will benefit from the safe application of a chemical commonly used for structural pest control. In accordance with the laws and regulations of the State of California, we are required to provide you and your occupants with the following information prior to any application of chemicals to such property. Please take a few moments to read and become familiar with the content.

State Law requires that you be given the following information:

"CAUTION - PESTICIDES ARE TOXIC CHEMICALS. Structural Pest Control Operators are licensed and regulated by the Structural Pest Control Board, and apply pesticides which are registered and approved for use by the California Department of Food and Agriculture and the United States Environmental Protection Agency. Registration is granted when the state finds that based on scientific evidence, there are no appreciable risks weighted by the benefits. The degree of risk depends on the degree of exposure, so exposure should be minimized."

"If within 24 hours following application, you experience symptoms similar to common seasonal illness comparable to the flu, contact your physician or poison control center and your pest control operator immediately."

For further information contact any of the following:

County Health Department-(661)868-0554
 County Poison Control Center - (800)876-4766
 County Agricultural Commissioner - (661)868-6300
 Structural Pest Control Board - (800)737-8188



RCB Inspections and Termite Control

3400 Panama Ln. Suite F #194

Bakersfield CA 93313

Tel 661-398-2151 Fax 661-836-2645

termitehawk@sbcglobal.net

AGREEMENT

No work will be performed until a signed copy of this agreement has been received.

Address of Property: 2108 CROMWELL CT
City: Bakersfield
State/Zip: CA 93304

The inspection report of the company dated, 1/7/09 is incorporated herein by reference as though fully set forth.

The company is authorized to proceed with the work outlined in the items circled below from the Termite Inspection Report for the property inspected, for a total sum of \$. This total amount is due and payable within Ten (10) days from completion repair work and/or chemical application.

THE COMPANY AGREES

To guarantee all repair completed by this company for one year from date of completion except for caulking, grouting or plumbing, which is guaranteed for a period of Ninety (90) days. We assume no responsibility for work performed by others, to be bound to perform this work for the price quoted in our cost breakdown for a period not to exceed 30 days, to use reasonable care in the performance of our work but to assume no responsibility for damage to any hidden pipes, wiring, or other facilities or to any shrubs, plants or roof.

THE OWNER OR OWNER'S AGENT AGREES

To pay for services rendered in any additional services requested upon completion of work to pay a service charge of one and one-half percent (1 1/2%) interest per month, or portion of any month, annual interest rate of eighteen percent (18%) on accounts exceeding the ten (10) day full payment schedule. The Owner grants to The Company a security interest in the property to secure payment sum for work and inspection fee completed. In case of non-payment by The Owner, reasonable attorney fees and costs of collection shall be paid by owner, whether suit be filed or not.

ALL PARTIES AGREE

If any additional work is deemed necessary by the local building inspector, said work will not be performed without additional authorization from owner or owner's agent. This contract price does not include the charge of any Inspection Report fees. Circle the items you wish performed by The Company, below and enter total amount above:

NOTICE TO OWNER

Under the California Mechanics Lien Law any structural pest control company which contracts to do work for you, any contractor, subcontractor, laborer, supplier or other person who helps to improve your property, but is not paid for his or her work or supplies, has a right to enforce a claim against your property. This means that after a court hearing, your property could be sold by a court officer and the proceeds of the sale used to satisfy the indebtedness. This can happen even if you have paid your structural pest control company in full if the subcontractor, laborers or suppliers remain unpaid.

To preserve their right to file a claim or lien against your property, certain claimants such as subcontractors or material suppliers are required to provide you with a document entitled "Preliminary Notice." Prime contractors and laborers for wages do not have to provide this notice. A Preliminary Notice is not a lien against your property. Its purpose is to notify you of persons who may have a right to file a lien against your property if they are not paid.

ITEMS

Prefix	Section 1	Section 2	Further Inspection	Others
2A	987.00			
3A	300.00			
4A		NO EST		
5A		NO EST		
5B			NO EST	

Total: 1,287.00

Grand: 1,287.00

Property Owner: _____

Date: _____

Inspected By: _____

Date: _____

Owner's Agent: _____

Date: _____