

# WOOD DESTROYING PESTS AND ORGANISMS INSPECTION REPORT

Building No. 8809	Street CANYON RIDGE	City Bakersfield	Zip 93306	Date of Inspection 10/22/2009	Number of Pages 3
<b>RCB Inspections and Termite Control</b> <b>3400 Panama Ln. Suite F #194</b> <b>Bakersfield CA 93313</b> <b>Tel 661-398-2151 Fax 661-836-2645</b> <b>termitehawk@sbcglobal.net</b>				Report # : 12063 Registration # : 4980 Escrow # :	
Ordered by: MIKE GRIGG ELITE AUCTION 1700 CHERRY ST BAKERSFIELD CA 93304		Property Owner and/or Party of Interest: 8809 CANYON RIDGE Bakersfield CA 93306		Report sent to: MIKE GRIGG ELITE AUCTION 1700 CHERRY ST BAKERSFIELD CA 93304	
COMPLETE REPORT <input checked="" type="checkbox"/> LIMITED REPORT <input type="checkbox"/> SUPPLEMENTAL REPORT <input type="checkbox"/> REINSPECTION REPORT <input type="checkbox"/>					
GENERAL DESCRIPTION: ONE STORY SINGLE FAMILY HOUSE VACANT				Inspection Tag Posted: GARAGE Other Tags Posted:	
An inspection has been made of the structure(s) shown on the diagram in accordance with the Structural Pest Control Act. Detached porches, detached steps, detached decks and any other structures not on the diagram were not inspected.					
Subterranean Termites <input type="checkbox"/> Drywood Termites <input type="checkbox"/> Fungus / Dryrot <input type="checkbox"/> Other Findings <input type="checkbox"/> Further Inspection <input type="checkbox"/> If any of the above boxes are checked, it indicates that there were visible problems in accessible areas. Read the report for details on checked items.					

**Diagram Not To Scale**

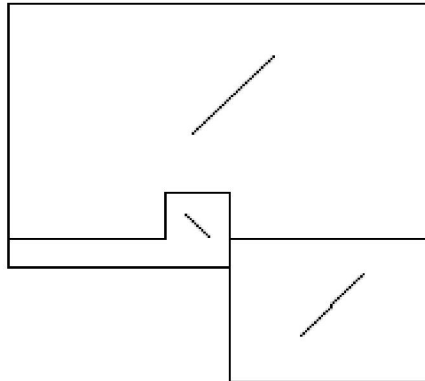

Front

Inspected By: James E. Blythe State License No. FR18377 Signature: *Jim Blythe*

You are entitled to obtain copies of all reports and completion notices on this property reported to the Structural Pest Control Board during the preceding two years. To obtain copies contact: Structural Pest Control Board, 1418 Howe Avenue, Suite 18, Sacramento, California, 95825-3204.

NOTE: Questions or problems concerning the above report should be directed to the manager of the company. Unresolved questions or problems with services performed may be directed to the Structural Pest Control Board at (916) 561-8708, (800) 737-8188 or [www.pestboard.ca.gov](http://www.pestboard.ca.gov). 43M-41 (Rev. 10/01)

# RCB Inspections and Termite Control

Page 2 of inspection report

8809	CANYON RIDGE	Bakersfield	CA	93306
Address of Property Inspected		City	State	Zip
	10/22/2009	12063		
Stamp No.	Date of Inspection	Co. Report No.	Escrow No.	

**WHAT IS A WOOD DESTROYING PEST & ORGANISM INSPECTION REPORT? READ THIS DOCUMENT. IT EXPLAINS THE SCOPE AND LIMITATIONS OF A STRUCTURAL PEST CONTROL INSPECTION AND A WOOD DESTROYING PEST & ORGANISM INSPECTION REPORT.**

A Wood Destroying Pest & Organism Inspection Report contains findings as to the presence or absence of evidence of wood destroying pests and organisms in visible and accessible areas and contains recommendations for correcting any infestations or infections found. The contents of Wood Destroying Pest & Organism Inspection Reports are governed by the Structural Pest Control Act and regulations.

Some structures do not comply with building code requirements or may have structural, plumbing, electrical, mechanical, heating, air conditioning or other defects that do not pertain to wood destroying organisms. A Wood Destroying Pest & Organism Inspection Report does not contain information on such defects, if any, as they are not within the scope of the licenses of either this company, or it's employees.

The Structural Pest Control Act requires inspection of only those areas which are visible and accessible at the time of inspection. Some areas of the structure are not accessible to inspection, such as the interior of hollow walls, spaces between floors, areas concealed by carpeting, appliances, furniture or cabinets. Infestations or infections may be active in these areas without visible and accessible evidence. If you desire information about areas that were not inspected, a further inspection may be performed at an additional cost. Carpets, furniture or appliances are not moved and windows are not opened during a routine inspection.

**The exterior Surface of the roof was not inspected. If you want the water tightness of the roof determined, you should contact a roofing contractor who is licensed by the Contractor's State License Board.**

This company does not certify or guarantee against any leakage, such as (but not limited to) plumbing, appliances, walls, doors, windows, any type of seepage, roof or deck coverings. This company renders no guarantee, whatsoever, against any infection, infestation or any other adverse condition which may exist in such areas or may become visibly evident in such area after this date. Upon request, further inspection of these areas would be performed at an additional charge.

In the event damage or infestation described herein is later found to extend further than anticipated, our bid will not include such repairs. **OWNER SHOULD BE AWARE OF THIS CLOSED BID WHEN CONTRACTING WITH OTHERS OR UNDERTAKING THE WORK HIMSELF/HERSELF.**

If requested by the person ordering this report, a re-inspection of the structure will be performed. Such requests must be within four (4) months of the date of this inspection. Every re-inspection fee amount shall not exceed the original inspection fee.

Wall paper, stain, or interior painting are excluded from our contract. New wood exposed to the weather will be prime painted, only upon request at an additional expense.

All pesticides and fungicides must be applied by a state certified applicator (sec. 8555 Business and Professions Code Division 3) and in accordance with the manufacturer's label requirements.

This company will reinspect repairs done by others within four months of the original inspection. A charge, if any, can be no greater than the original inspection fee for each reinspection. The reinspection must be done within ten (10) working days of request. The reinspection is a visual inspection and if inspection of concealed areas is desired, inspection of work in progress will be necessary. Any guarantees must be received from parties performing repairs.

**“NOTICE: Reports on this structure prepared by various registered companies should list the same findings (i.e. termite infestations, termite damage, fungus damage, etc.). However, recommendations to correct these findings may vary from company to company. You have a right to seek a second opinion from another company.”**

**This Wood Destroying Pest & Organisms Report DOES NOT INCLUDE MOLD or any mold like conditions. No reference will be made to mold or mold-like conditions. Mold is not a Wood Destroying Organism and is outside the scope of this report as defined by the Structural Pest Control Act. If you wish your property to be inspected for mold or mold like conditions, please contact the appropriate mold professional.**

## RCB Inspections and Termite Control

Page 3 of 3 of Standard Inspection Report

8809	CANYON RIDGE	Bakersfield	CA	93306
Address of Property Inspected		City	State	Zip
Stamp No.	10/22/2009	12063	Escrow No.	
	Date of Inspection	Co. Report No.		

SECTION I CONTAINS ITEMS WHERE THERE IS EVIDENCE OF ACTIVE INFESTATION, INFECTION OR CONDITIONS THAT HAVE RESULTED IN OR FROM INFESTATION OR INFECTION.

SECTION II ITEMS ARE CONDITIONS DEEMED LIKELY TO LEAD TO INFESTATION OR INFECTION BUT WHERE NO VISIBLE EVIDENCE OF SUCH WAS FOUND.

FURTHER INSPECTION ITEMS ARE DEFINED AS RECOMMENDATIONS TO INSPECT AREA(S) WHICH DURING THE ORIGINAL INSPECTION DID NOT ALLOW THE INSPECTOR ACCESS TO COMPLETE HIS INSPECTION AND CANNOT BE DEFINED AS SECTION I OR II.

THIS IS TO CERTIFY THAT THE ABOVE PROPERTY WAS INSPECTED ON 10/22/09 IN ACCORDANCE WITH THE STRUCTURAL PEST CONTROL ACT AND RULES AND REGULATIONS ADOPTED PURSUANT THERETO, AND THAT NO EVIDENCE OF ACTIVE INFESTATION WAS FOUND IN VISIBLE AND ACCESSIBLE AREAS. This complies with VA and FHA requirements.