

# WOOD DESTROYING PESTS AND ORGANISMS INSPECTION REPORT

Building No. 2731	Street TALISMAN DR	City Bakersfield	Zip 93304	Date of Inspection 1/13/2010	Number of Pages 4
----------------------	-----------------------	---------------------	--------------	---------------------------------	----------------------

## RCB Inspections and Termite Control

3400 Panama Ln. Suite F #194

Bakersfield CA 93313

Tel 661-398-2151 Fax 661-836-2645

termitehawk@sbcglobal.net

Report #: 12342

Registration #: 4980

Escrow #:

<b>Ordered by:</b> MIKE GRIGG ELITE AUCTION 1700 CHERRY ST BAKERSFIELD CA 93304	<b>Property Owner and/or Party of Interest:</b> 2731 TALISMAN DR Bakersfield CA 93304	<b>Report sent to:</b> MIKE GRIGG ELITE AUCTION 1700 CHERRY ST BAKERSFIELD CA 93304
---	---	---

COMPLETE REPORT 
 LIMITED REPORT 
 SUPPLEMENTAL REPORT 
 REINSPECTION REPORT

<b>GENERAL DESCRIPTION:</b> TWO STORY SINGLE FAMILY HOUSE VACANT	Inspection Tag Posted: CLOSET
	Other Tags Posted:

An inspection has been made of the structure(s) shown on the diagram in accordance with the Structural Pest Control Act. Detached porches, detached steps, detached decks and any other structures not on the diagram were not inspected.

Subterranean Termites 
 Drywood Termites 
 Fungus / Dryrot 
 Other Findings 
 Further Inspection

If any of the above boxes are checked, it indicates that there were visible problems in accessible areas. Read the report for details on checked items.

Diagram Not To Scale

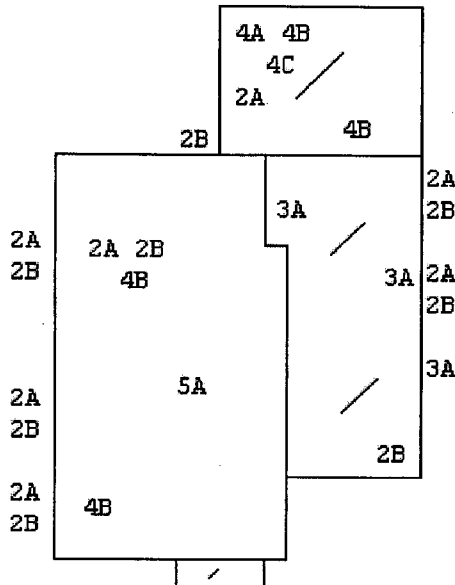

Front

Inspected By: James E. Blythe State License No. FR18377 Signature: *Jim Blythe*

You are entitled to obtain copies of all reports and completion notices on this property reported to the Structural Pest Control Board during the preceding two years. To obtain copies contact: Structural Pest Control Board, 1418 Howe Avenue, Suite 18, Sacramento, California, 95825-3204.

NOTE: Questions or problems concerning the above report should be directed to the manager of the company. Unresolved questions or problems with services performed may be directed to the Structural Pest Control Board at (916) 561-8708, (800) 737-8188 or [www.pestboard.ca.gov](http://www.pestboard.ca.gov).

# RCB Inspections and Termite Control

Page 2 of inspection report

2731	TALISMAN DR	Bakersfield	CA	93304
Address of Property Inspected		City	State	Zip
Stamp No.	1/13/2010	12342	Escrow No.	
	Date of Inspection	Co. Report No.		

**WHAT IS A WOOD DESTROYING PEST & ORGANISM INSPECTION REPORT? READ THIS DOCUMENT. IT EXPLAINS THE SCOPE AND LIMITATIONS OF A STRUCTURAL PEST CONTROL INSPECTION AND A WOOD DESTROYING PEST & ORGANISM INSPECTION REPORT.**

A Wood Destroying Pest & Organism Inspection Report contains findings as to the presence or absence of evidence of wood destroying pests and organisms in visible and accessible areas and contains recommendations for correcting any infestations or infections found. The contents of Wood Destroying Pest & Organism Inspection Reports are governed by the Structural Pest Control Act and regulations.

Some structures do not comply with building code requirements or may have structural, plumbing, electrical, mechanical, heating, air conditioning or other defects that do not pertain to wood destroying organisms. A Wood Destroying Pest & Organism Inspection Report does not contain information on such defects, if any, as they are not within the scope of the licenses of either this company, or it's employees.

The Structural Pest Control Act requires inspection of only those areas which are visible and accessible at the time of inspection. Some areas of the structure are not accessible to inspection, such as the interior of hollow walls, spaces between floors, areas concealed by carpeting, appliances, furniture or cabinets. Infestations or infections may be active in these areas without visible and accessible evidence. If you desire information about areas that were not inspected, a further inspection may be performed at an additional cost. Carpets, furniture or appliances are not moved and windows are not opened during a routine inspection.

**The exterior Surface of the roof was not inspected. If you want the water tightness of the roof determined, you should contact a roofing contractor who is licensed by the Contractor's State License Board.**

This company does not certify or guarantee against any leakage, such as (but not limited to) plumbing, appliances, walls, doors, windows, any type of seepage, roof or deck coverings. This company renders no guarantee, whatsoever, against any infection, infestation or any other adverse condition which may exist in such areas or may become visibly evident in such area after this date. Upon request, further inspection of these areas would be performed at an additional charge.

In the event damage or infestation described herein is later found to extend further than anticipated, our bid will not include such repairs. **OWNER SHOULD BE AWARE OF THIS CLOSED BID WHEN CONTRACTING WITH OTHERS OR UNDERTAKING THE WORK HIMSELF/HERSELF.**

If requested by the person ordering this report, a re-inspection of the structure will be performed. Such requests must be within four (4) months of the date of this inspection. Every re-inspection fee amount shall not exceed the original inspection fee.

Wall paper, stain, or interior painting are excluded from our contract. New wood exposed to the weather will be prime painted, only upon request at an additional expense.

All pesticides and fungicides must be applied by a state certified applicator (sec. 8555 Business and Professions Code Division 3) and in accordance with the manufacturer's label requirements.

This company will reinspect repairs done by others within four months of the original inspection. A charge, if any, can be no greater than the original inspection fee for each reinspection. The reinspection must be done within ten (10) working days of request. The reinspection is a visual inspection and if inspection of concealed areas is desired, inspection of work in progress will be necessary. Any guarantees must be received from parties performing repairs.

**"NOTICE: Reports on this structure prepared by various registered companies should list the same findings (i.e. termite infestations, termite damage, fungus damage, etc.). However, recommendations to correct these findings may vary from company to company. You have a right to seek a second opinion from another company."**

**This Wood Destroying Pest & Organisms Report DOES NOT INCLUDE MOLD or any mold like conditions. No reference will be made to mold or mold-like conditions. Mold is not a Wood Destroying Organism and is outside the scope of this report as defined by the Structural Pest Control Act. If you wish your property to be inspected for mold or mold like conditions, please contact the appropriate mold professional.**

# RCB Inspections and Termite Control

Page 3 of 4 of Standard Inspection Report

2731	TALISMAN DR	Bakersfield	CA	93304
Address of Property Inspected		City	State	Zip
Stamp No.	1/13/2010	12342	Escrow No.	
	Date of Inspection	Co. Report No.		

SECTION I CONTAINS ITEMS WHERE THERE IS EVIDENCE OF ACTIVE INFESTATION, INFECTION OR CONDITIONS THAT HAVE RESULTED IN OR FROM INFESTATION OR INFECTION.

SECTION II ITEMS ARE CONDITIONS DEEMED LIKELY TO LEAD TO INFESTATION OR INFECTION BUT WHERE NO VISIBLE EVIDENCE OF SUCH WAS FOUND.

FURTHER INSPECTION ITEMS ARE DEFINED AS RECOMMENDATIONS TO INSPECT AREA(S) WHICH DURING THE ORIGINAL INSPECTION DID NOT ALLOW THE INSPECTOR ACCESS TO COMPLETE HIS INSPECTION AND CANNOT BE DEFINED AS SECTION I OR II.

## 2. DRYWOOD TERMITES:

2A - FINDING - Evidence of drywood termite infestation noted in areas marked on diagram.

RECOMMENDATION - Cover entire structure(s) and fumigate for the elimination of drywood termites. Cover or remove accessible termite pellets.

\*NOTE\*: When a property is fumigated, our crew must walk on the roof surfaces and perimeter areas of the building in order to put the tarps in place, and damage may occur to certain types of roofs, roofs eaves, roof ridges and/or roof corners. Neither RCB nor its licensed fumigator will assume any liability for such damage or consequential damage that may occur to roofs or roof coverings and areas below roofs.  
SECTION 1

2B - FINDING - Fungus and termite damaged wood noted at areas marked on diagram.

RECOMMENDATION - Repair fungus and termite damage at wood siding, support post, roof eaves, deck and wood floor. Painting is not included in this estimate.  
SECTION 1

## 3. FUNGUS / DRYROT:

3A - FINDING - Fungus damaged wood noted as indicated on diagram.

RECOMMENDATION - Replace fungus damaged wood eaves at area marked on diagram. Owner to contact licensed roofing company to repair roof surfaces at areas of wood replacement. (\_\_\_\_\_) Customers initials  
SECTION 1

## 4. OTHER FINDINGS:

4A - FINDING - Leak(s) noted in shower enclosure marked on diagram.

RECOMMENDATION - Owner to have area(s) at shower inspected by a qualified tradesman and repair or replace as may be deemed necessary.  
SECTION 2

4B - FINDING - Water stains noted wall, ceiling and floor as indicated on diagram.

RECOMMENDATION - Periodically inspect area.  
SECTION 2

4C - FINDING - Leak noted at toilet seal as marked on diagram.

RECOMMENDATION - Owner to contact a licensed tradesman to make necessary repairs.  
SECTION 2

## 5. FURTHER INSPECTION:

5A - FINDING - Inaccessible area marked on diagram.

## RCB Inspections and Termite Control

Page 4 of 4 of Standard Inspection Report

2731	TALISMAN DR	Bakersfield	CA	93304
Address of Property Inspected		City	State	Zip
	1/13/2010	12342		
Stamp No.	Date of Inspection	Co. Report No.	Escrow No.	

RECOMMENDATION - If inspection of area(s) at sub area is required it must be made accessible. We will then re-inspect and issue a supplemental report of our new findings. RCB recommends further inspection of this area. FURTHER INSPECTION IF REQUIRED

\*Note\* When replacement material is used, an exact match cannot be guaranteed. All replacement material will be of current industry sizing.

\*Note\* Fumigation is warranted for a period of two (2) years.

\*Note\* RCB will prime replace wood of finish-paint replace wood with owner provided paint. There is no paint match warranty.

\*Note\* If termite of dry rot damage extends into inaccessible or hidden areas, a supplemental report will be issued and a new estimate to complete the repairs will be provided.

"Thank you for selecting our company to perform a structural pest control inspection on your property. Our inspectors have determined that your property will benefit from the safe application of a chemical commonly used for structural pest control. In accordance with the laws and regulations of the State of California, we are required to provide you and your occupants with the following information prior to any application of chemicals to such property. Please take a few moments to read and become familiar with the content.

State Law requires that you be given the following information:

"CAUTION - PESTICIDES ARE TOXIC CHEMICALS. Structural Pest Control Operators are licensed and regulated by the Structural Pest Control Board, and apply pesticides which are registered and approved for use by the California Department of Food and Agriculture and the United States Environmental Protection Agency. Registration is granted when the state finds that based on scientific evidence, there are no appreciable risks weighed by the benefits. The degree of risk depends on the degree of exposure, so exposure should be minimized."

"If within 24 hours following application, you experience symptoms similar to common seasonal illness comparable to the flu, contact your physician or poison control center and your pest control operator immediately."

For further information contact any of the following:

County Health Department-408-555-1111  
County Poison Control Center - 408-555-2222  
County Agricultural Commissioner - 408-555-3333  
Structural Pest Control Board - 916-263-2540

